

SHAKE MACHINE AGITATOR PADDLE UPGRADE

A NEW UPDATE **ONLY** FOR TAYLOR SHAKE/SUNDAE MACHINES ACROSS THE CANADIAN SYSTEM

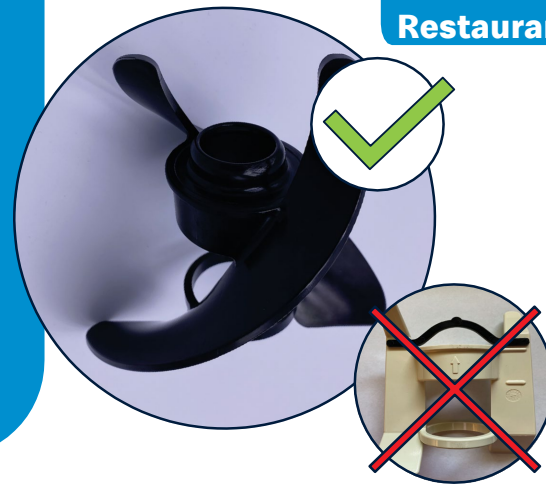

WHY?

- People **love** our shakes and sundaes, and are disappointed when our machines are not working.
- Along with **proper routine maintenance and cleaning**, replacing the agitator paddle will begin to help increase shake machine uptime by 3-5%.

UPGRADE TIMELINE

- The Taylor Service Companies (DSL / TFI / Bazinet Taylor) will start shipping two agitators for each Shake/Sundae machine starting February, 2024.
- **Upon receipt, follow the steps on the left to replace with the new agitators.**
- **An optional software upgrade** will be offered on your next brush / certification visit (Cost: \$100). This can further improve success on the Heat Treat cycle (additional 5-7 mins) to ensure your machine is ready for lunch time service! Contact your Taylor Service Company for details.

ACTION

Follow these simple steps to replace your shake machine agitator:



1. Wash, rinse, sanitize, and air dry new agitator paddles

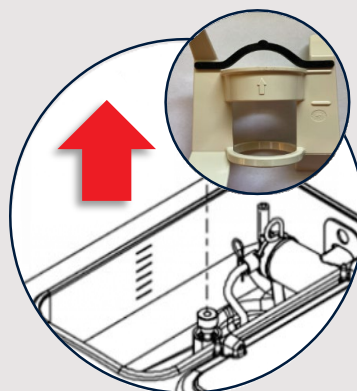

2. Remove current agitator paddle from both sides of the machine

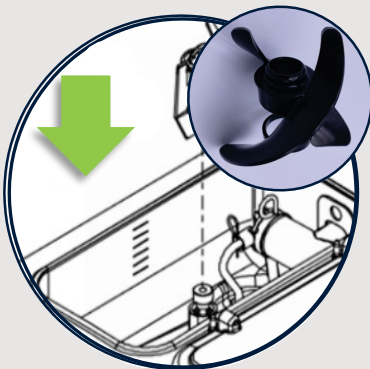

3. Replace with new agitator paddles



4. Toss the old agitator paddles



COMPLETE BY MARCH 1, 2024



- Access the **Taylor Tips website** for an assortment of helpful videos, tips, and planned maintenance cards.

